



# MAGURA

① Unsere weltweiten Handelspartner und Service Center finden Sie unter **www.magura.com**

① Check out our worldwide partners and service centers at **www.magura.com**

## Deutschland

MAGURA Bike Parts GmbH & Co. KG  
Eckisstraße 6  
D-72574 Bad Urach

phone +49 71 25 96 94 6-0

fax +49 71 25 96 94 6-17

info@magura.de

## Asia

MAGURA Asia Limited Co.  
No. 9, Industrial Park, 10<sup>th</sup> Road  
Taichung City  
40755 Taichung City, Taiwan

phone +886 4 23 59 85 55

fax +886 4 23 59 99 10

info@magura.com.tw

## USA

MAGURA USA  
724 West Clem  
62450 Olney, Illinois

phone +1 618 395-2200

fax +1 618 395-4711

magura@magurausa.com



### GARANTIE

auf Dichtheit von  
Bremsgriff,  
Bremszylindern  
und -zange

Informationen zur  
5-Jahres Dichtigkeits-Garantie  
unter **www.magura.com**



leakproof  
**WARRANTY**  
on levers,  
brake cylinders  
and calipers

Information on  
5-year leakproof warranty  
at **www.magura.com**

Welcome to the Passion People



02.2014

## MAGURA MY15+ short instruction

## MAGURA

### 1.Brake Mounting

#### 1.1 Rotor mounting

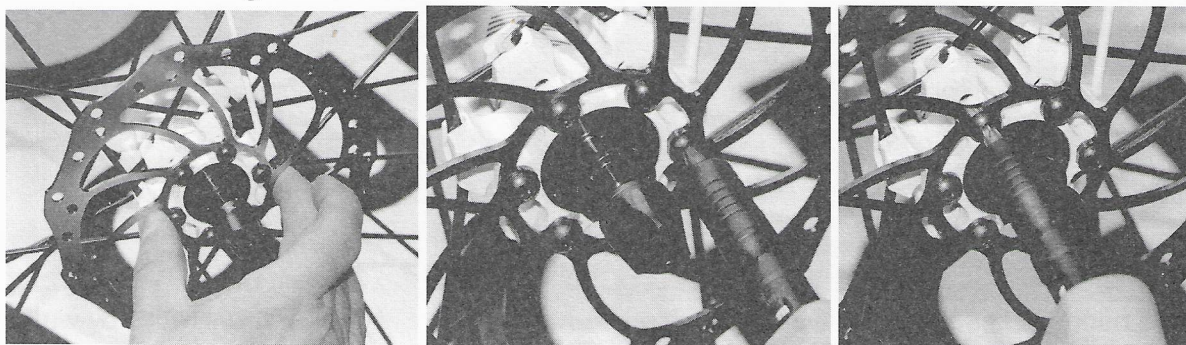

Check the rotation direction according to the arrow. Use the correct torque: **4Nm**.

#### 1.2 Master mounting

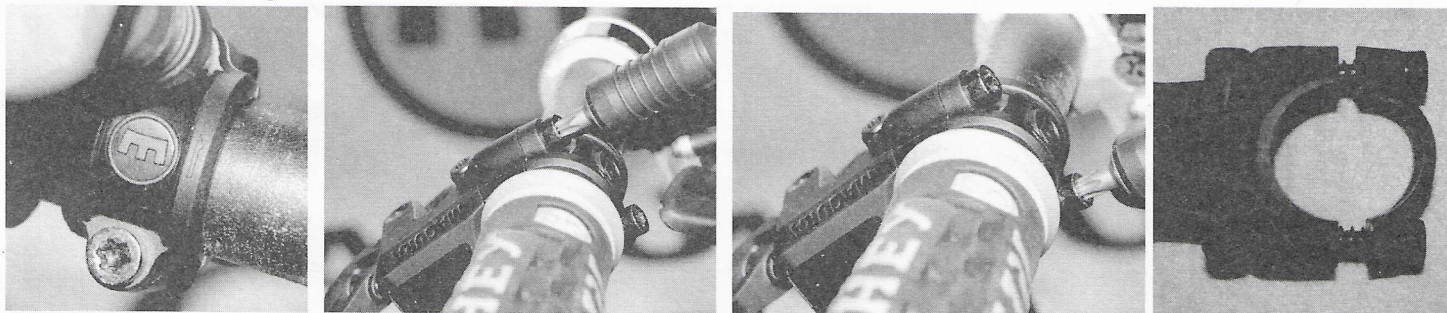

If necessary remove the clamp, tighten first the upper screw to block with **4Nm**, then the lower screw.

TAKE care about the correct position of the clamp: the arrow or logo must point upwards. The thicker part on Carbolay clamps must be on the upper screw!

#### 1.3 Calliper assembly

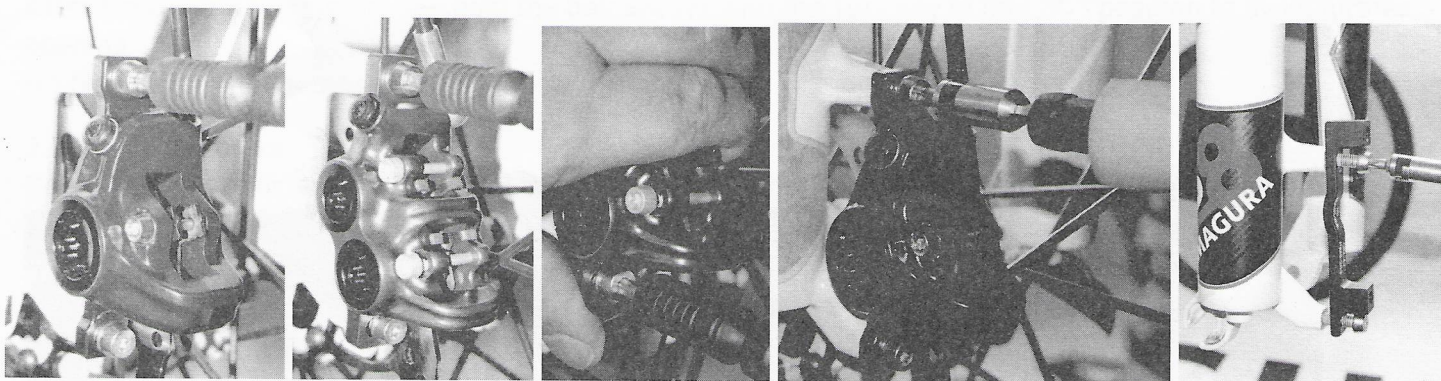

Assemble the calliper to frame/fork after installing the wheel with the rotor.

Press the brake lever, so the calliper will be centred over the rotor.

Fix the calliper by tightening the calliper bolts slightly and check, if the rotor spins drag-free.

If the rotor spins drag-free, tighten the bolts with the correct torque of **6Nm**, check again if it runs drag-free.

If you need an adaptor, mount first the adaptor onto frame/fork, then the calliper and after that the calliper in the same way as described above



## 2 Shortening and routing the line

### 2.2 Prepare for shortening the line

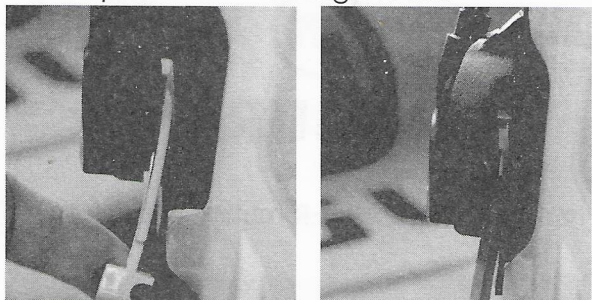

Push back the pistons **CAREFULLY** by using the transport device or a flat screwdriver.



### 2.3 Take out the line

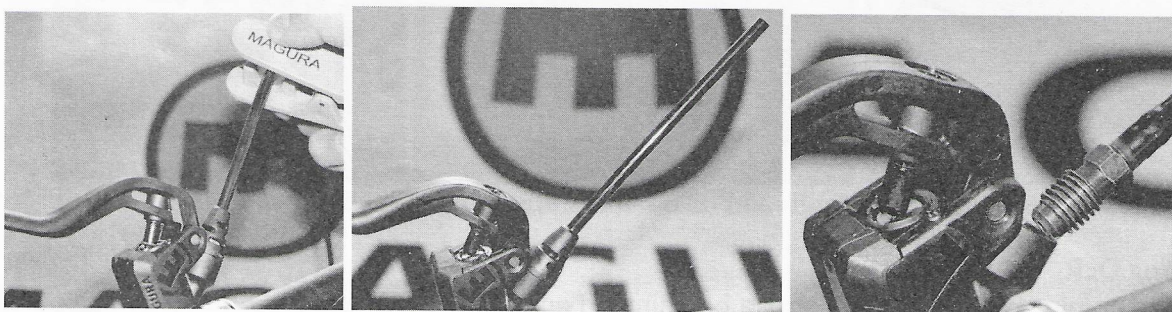

If possible cut the line about 10cm/4" away from the master cylinder.

Use an 8mm open end spanner and take out the sleeve nut and pull out the line.

**ATTENTION MT2: you can throw away the barbed fitting, the barbed fitting will be replaced with a NEW sleeve nut and NEW olive, NO insert needed here!**

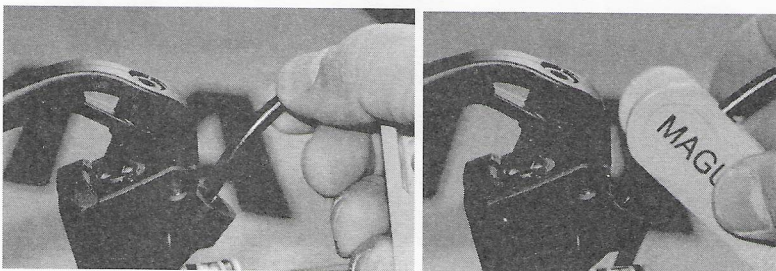

Take the line now and check the correct length you need and shorten it as required.

**TAKE care and hold the line to avoid loss of oil!**

### 2.4 Install new olive and insert. **ATTENTION MT2: the insert is NOT necessary!!**

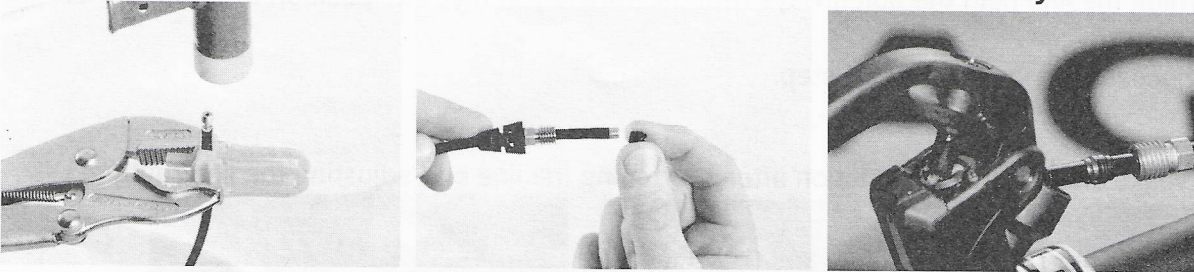

Press in the new insert,

slide the sleeve nut and new olive over the line ,

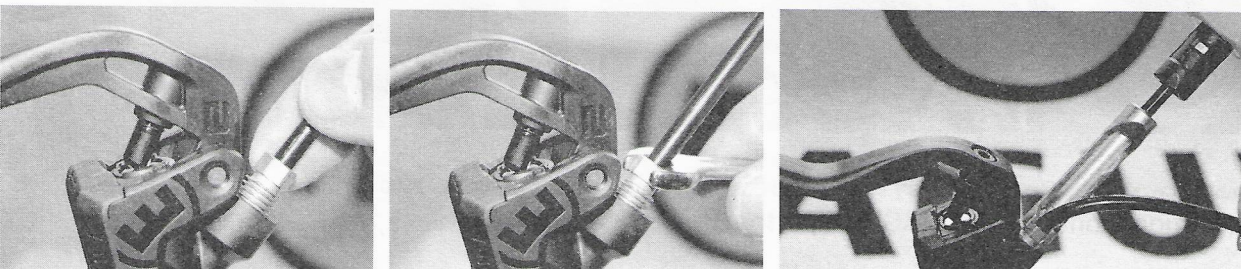





# MAGURA

**Attention:** if the line is routed through the frame, shorten it to the required length **AFTER** routing through the frame. If possible use a plug to close the line during this process.

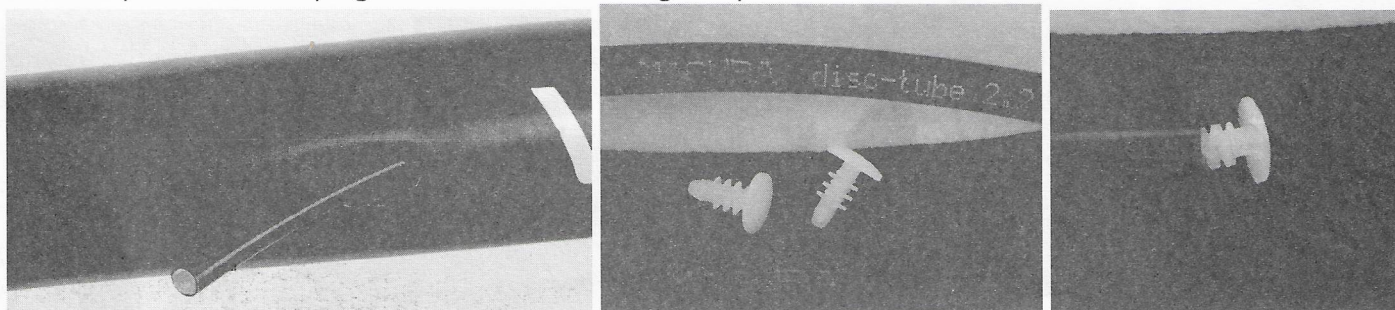

Now you can shorten the line to the required length and follow the steps as described above.

## 2.5 Optimal Line Routing OLR

The exit angle of the line coming out of the calliper can be adjusted on MAGURA MT brakes with banjo callipers for perfect line routing.

**YES**

**NO**



Take a Torx T25 key and unscrew the bolt which holds the line by opening 30° counterclockwise.

Now you can turn and adjust the angle of the line as required.

When adjusted, tighten bolt with **3Nm**.

**Attention:** when turning the line hold the bolt always with the Torx key in that 30° position to avoid further opening.

No bleeding will be necessary if you follow this step.

## 2.6 Check the brake

Check the brake for leaks and control the function after shortening the line and adjusting the line routing.

